

TDR-10 TIMED POWER RELAY



Front Panel

Sets ON time...from a fraction of a second to 100 hours

- *Switches on AC Outlet for Preset Time
- *Triggered by Motion Sensor or Pushbutton
- *Protects Artifacts from Excess Light Exposure
- *Adjustable from Seconds to Hours

The TDR-10 Timed Power Relay serves to turn on a standard 120 Volt outlet for a preset amount of time. This timed interval is initiated when a contact is made across the Start terminals on the rear panel. This low voltage contact may come from a pushbutton, motion sensor, or other device.

Once triggered, the timing cycle starts and the outlet switches on. While timing, any additional start signals force the timing cycle to begin anew. This ensures that there will be at least one complete cycle after the last start signal. For example, if used with a motion sensor such as the Museum Technology BB-200, the first visitor to approach will turn on the AC outlet for the preset time. If no further motion is sensed, the outlet will switch off at the end of the preset time. Should another visitor approach while the outlet is on, the TDR-10 will start the timing cycle from the beginning. In this way, as long a visitor motion is detected, the outlet will remain on, shutting off only after motion has not been sensed for the preset time.

Switched 120 Volt Outlet to power exhibit

Screw terminals to connect to motion sensor or pushbutton

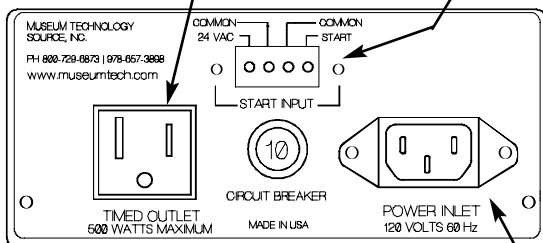

Rear Panel

Connect to 120 Volt supply with supplied cord

Specifications

Timing Range:	.05 seconds to 100 Hours
Accuracy:	Within .05%
Input Voltage:	120 Volts, 60 Hz
Switching Capacity:	500 Watts
AC Power Input:	Detachable IEC Cord supplied
AC Power Output:	One standard NEMA-15 AC outlet
Motion Sensor Power:	24 Volts AC, 200 mA
Start Input	4 position 5.08 mm plug with screw terminals.
Physical:	5.5" wide 5" deep 2.5" high, 2 lb
Case:	Aluminum Extrusion and steel
Warranty:	2 Years Parts and Labor
Country of Origin:	United States

Museum Technology Source Inc.

323 Andover Street Wilmington MA 01887
800-729-6873 | 978-657-3898 | f 978-657-7132

www.museumtech.com

Installation

Locate the TDR-10 so as to minimize the length of the AC power cable and the cord going to the lights (or other device) to be controlled. The drawing below shows the connections to be used if the TDR-10 is used in conjunction with a Museum Technology BB-200 Motion Sensor. If a pushbutton or other form of normally open switch is employed it is connected between the COMMON and START screw terminals. The cable connecting the TDR-10 and the BB-200 carries only low voltage and may be any reasonable length up to several hundred feet provided wire of at least 22 gauge is used. For ease of installation, the green screw terminal block may be disconnected from the TDR-10 by simply pulling it out.

Plug the cable from the exhibit into the TIMED OUTLET. Connect the supplied power cord to the POWER INLET and plug the other end into a source of 120 Volts AC of sufficient capacity to operate the load.

Although ventilation is not required, the TDR-10 should remain accessible for adjustment or service.

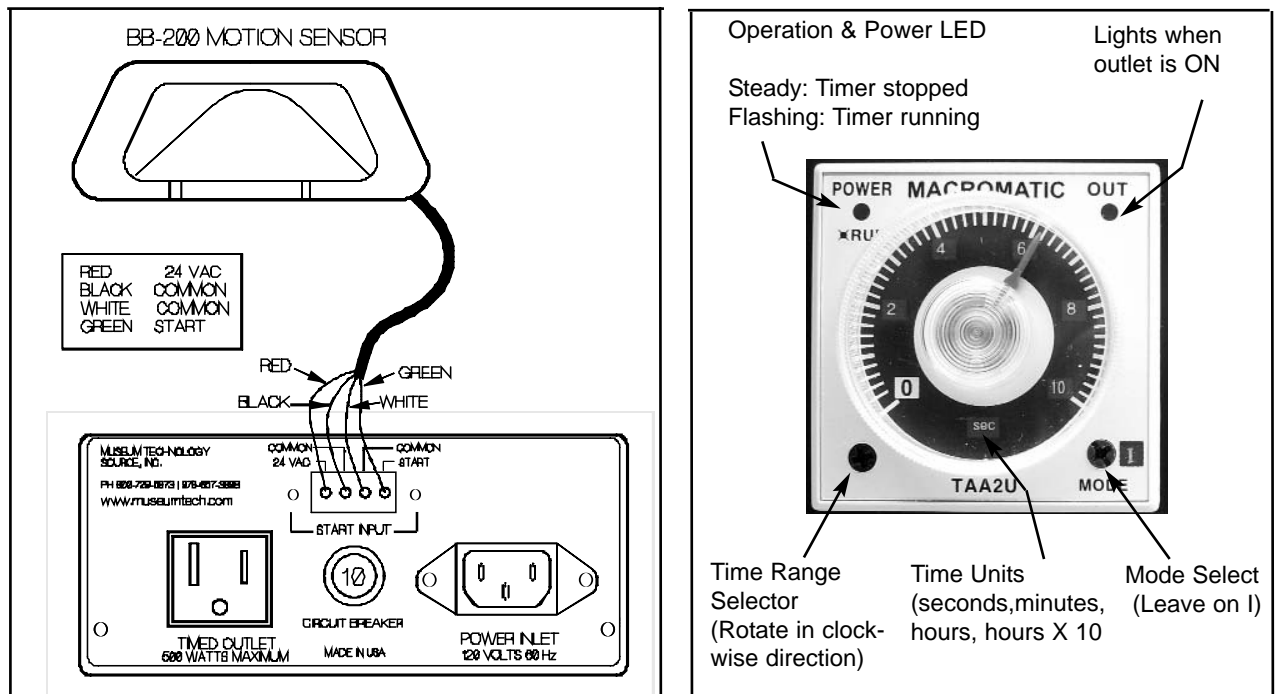

Setting the time

As shipped, the Time Range is set at 0 to 10 minutes. To set the time, simply rotate the knob to the desired setting. If a shorter or longer time is needed, use a small screwdriver to rotate the TIME RANGE switch (turn clockwise). The TIME UNITS display will change to indicate either seconds or hours. In addition, number will appear at cardinal points on the dial indicating the new calibration (0, 2, 4... or 0, 20, 40 etc)

Museum Technology Source Inc.

323 Andover Street Wilmington MA 01887
800-729-6873 | 978-657-3898 | f 978-657-7132

www.museumtech.com

Rev A August 2012